



WV WESTWOODLEBER

**WV WESTWOODLEBER**  
LET US GUIDE YOU HOME

Rye Road, Hoddesdon, EN11 0HP  
£395,000



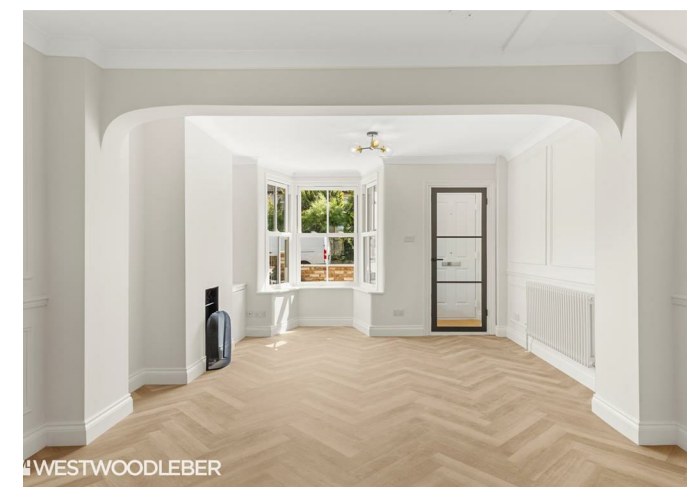

## Rye Road, Hoddesdon, EN11 0HP

**\*\*UNEXPECTEDLY BACK ON THE MARKET\*\***

Westwood Leber are delighted to bring to the market this truly stunning, newly refurbished two bedroom, mid-terrace period home well positioned in the heart of Hoddesdon. This property benefits from two double bedrooms, a beautiful refitted four-piece bathroom suite, stylishly updated kitchen with Quartz worktops and a larger than average rear garden. This family home has recently been tastefully refurbished by the current owner and offers excellent living accommodation and a wealth of character throughout! An early viewing is highly recommended.



**WL WESTWOODLEBER**

**WL WESTWOODLEBER**  
LET US GUIDE YOU HOME

## Ground Floor

Approx. 31.8 sq. metres (342.1 sq. feet)



## First Floor

Approx. 31.6 sq. metres (340.1 sq. feet)

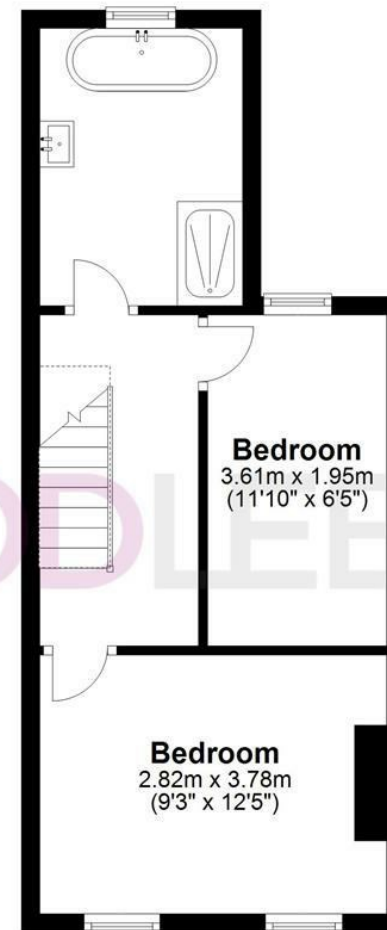

Total area: approx. 63.4 sq. metres (682.2 sq. feet)

THE FLOORPLAN IS FOR ILLUSTRATIVE PURPOSES ONLY AND IS NOT TO SCALE. Measurements and features are approximate and may differ from the actual property. Verify all details independently; no liability is accepted for errors or omissions.

Property marketing provided by [www.fotomarketing.co.uk](http://www.fotomarketing.co.uk)  
Plan produced using PlanUp.

















